

# ANEXO 1

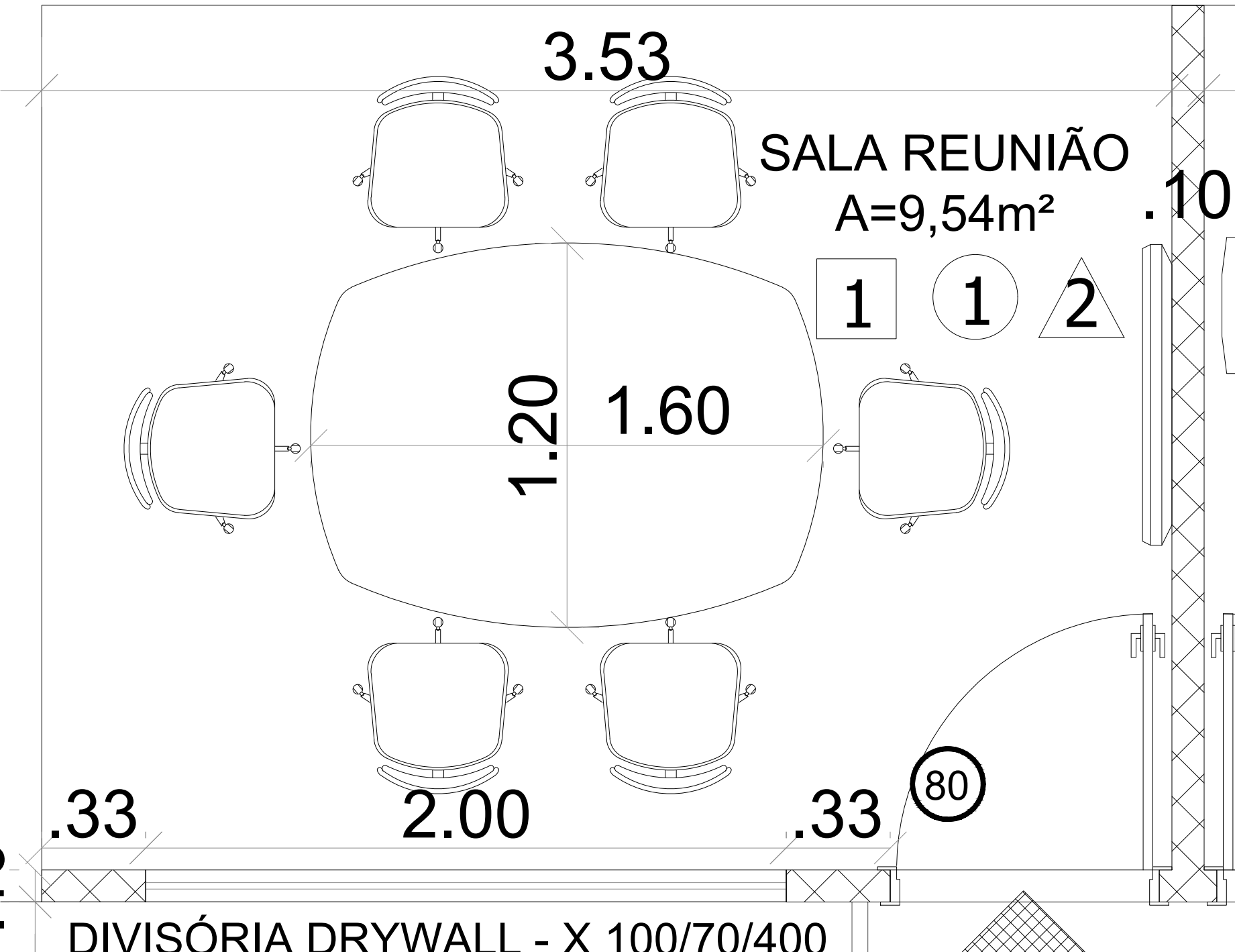

ANEXO 2

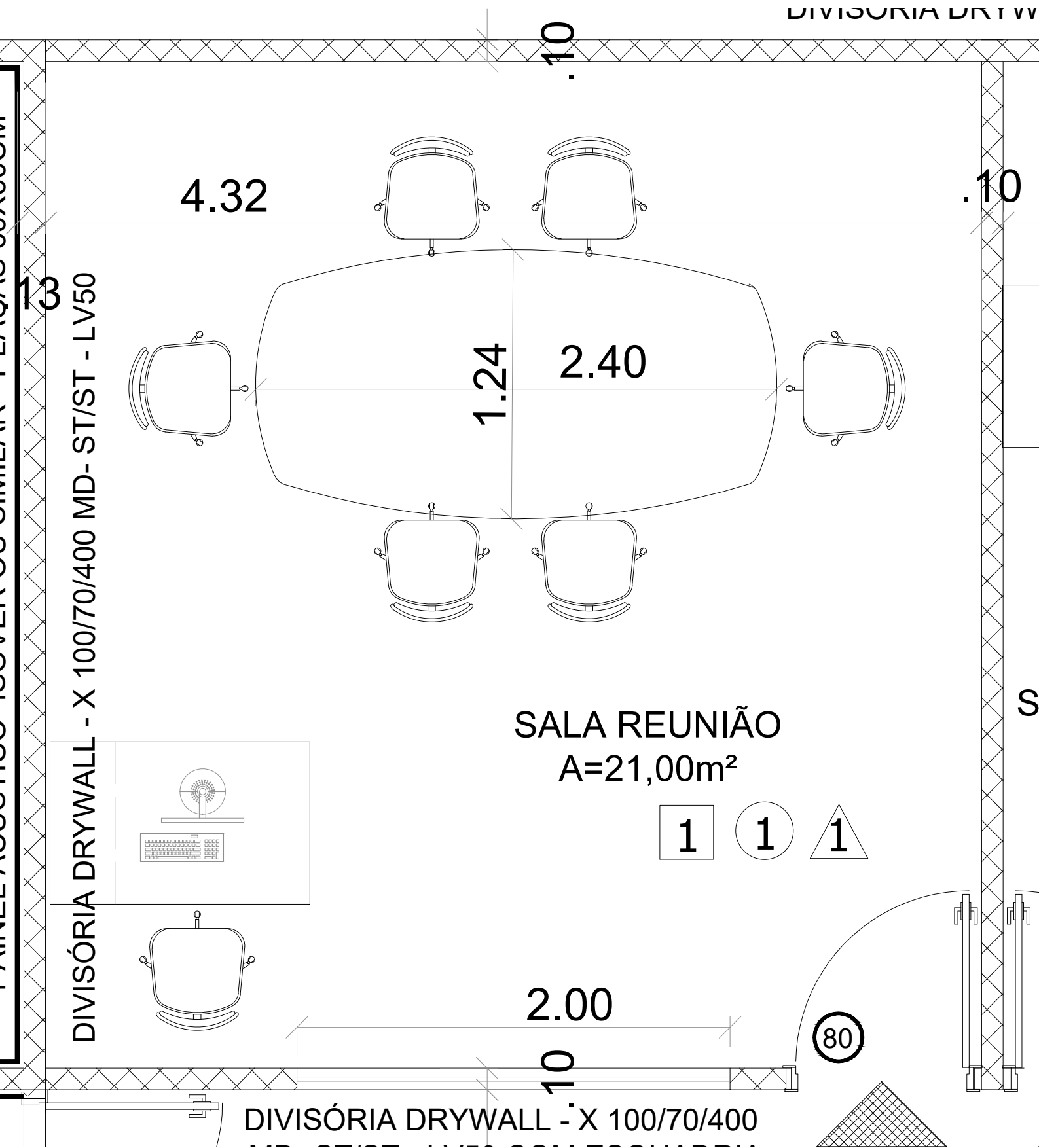

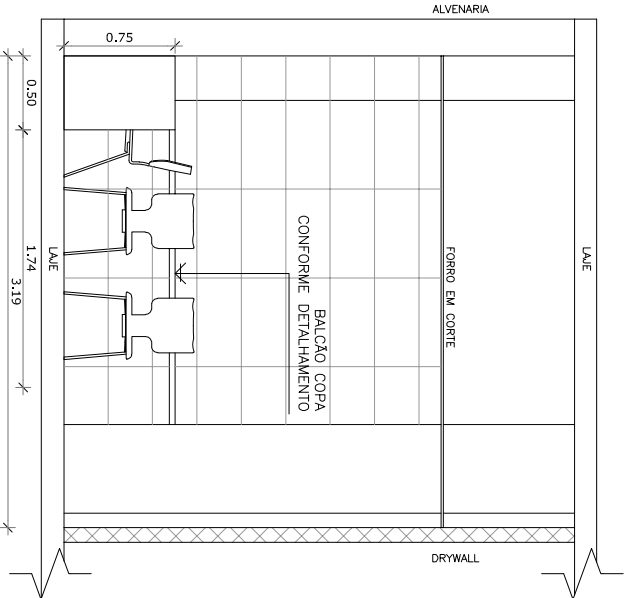
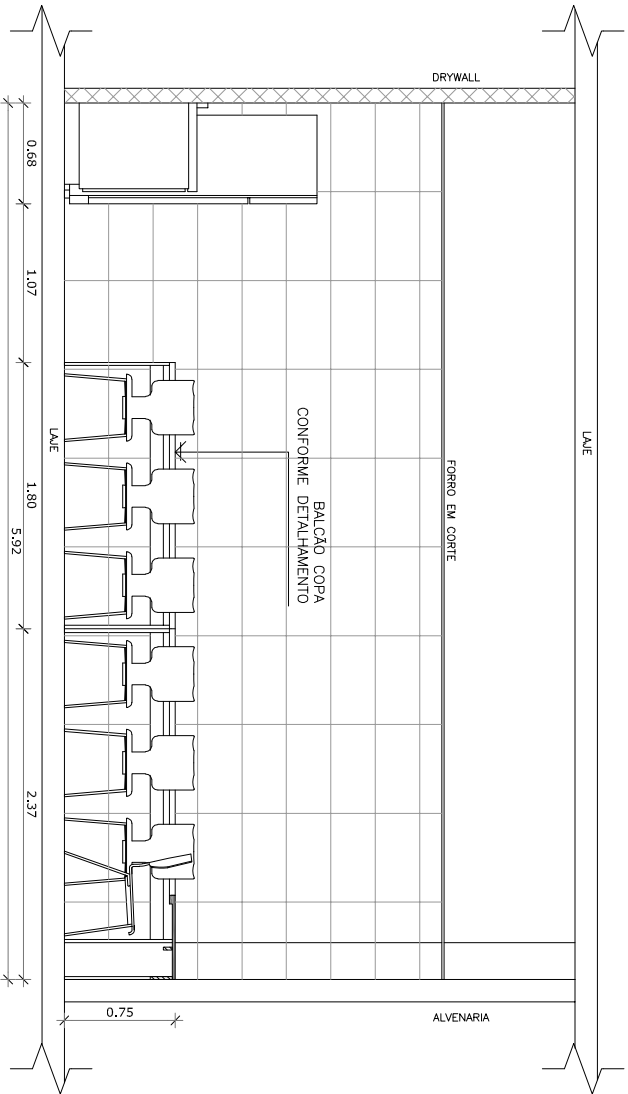
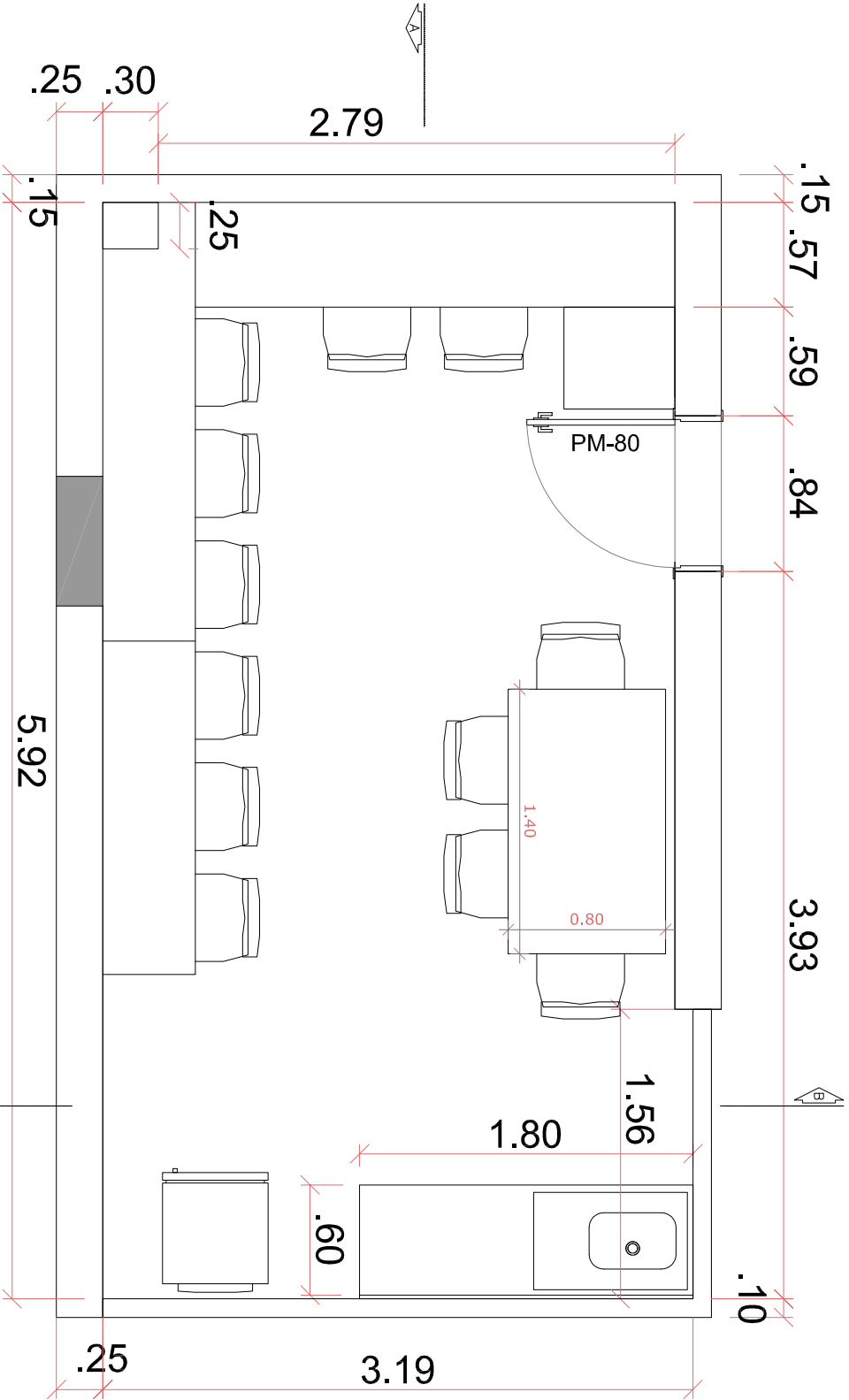

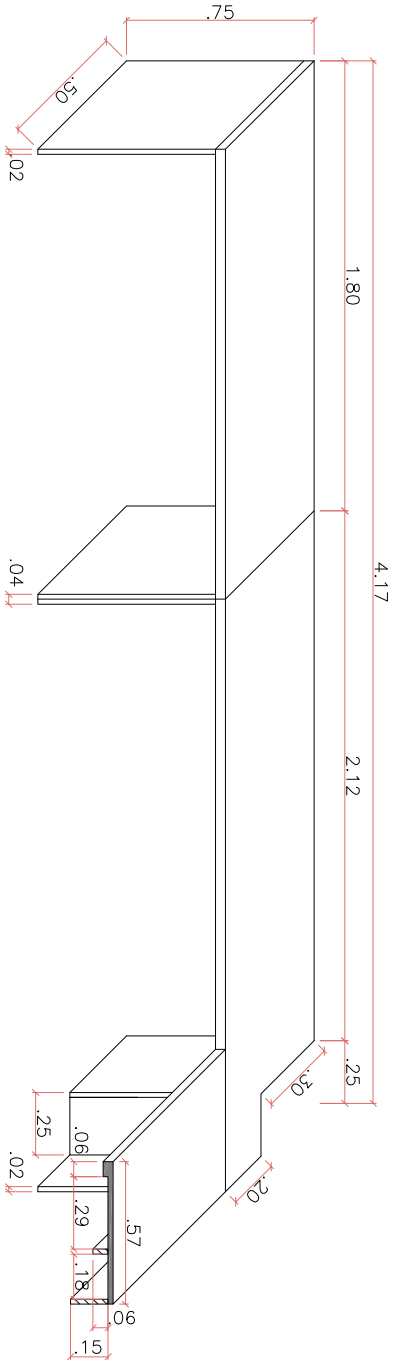

DET. MÓVEL COPA - VISTA A

ESCALA 1/25

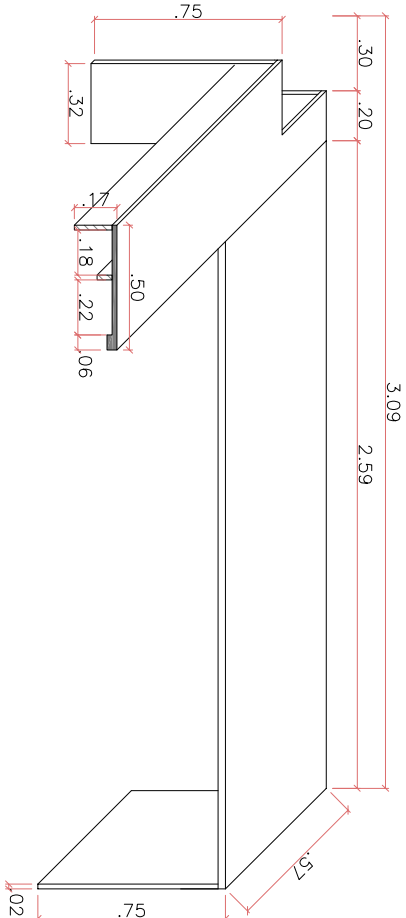

DET. MÓVEL COPA - VISTA B

ESCALA 1/25

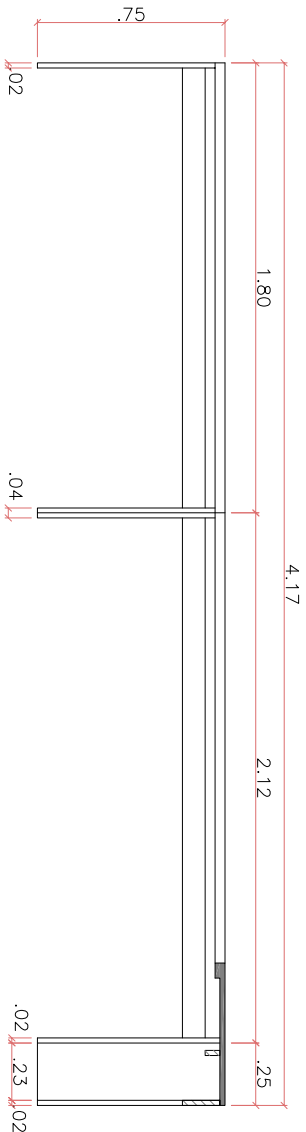

DET. MÓVEL COPA - VISTA A

ESCALA 1/25

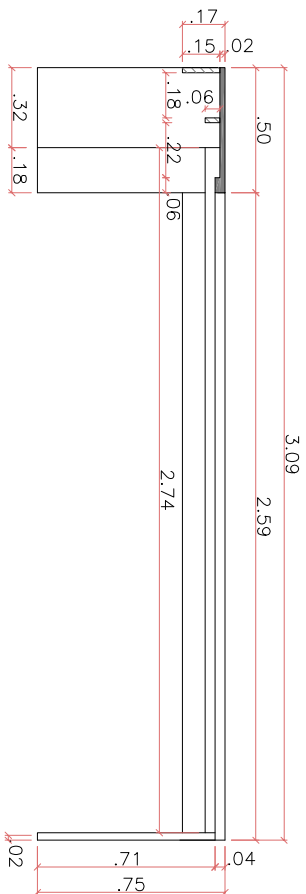

DET. MÓVEL COPA - VISTA B

ESCALA 1/25

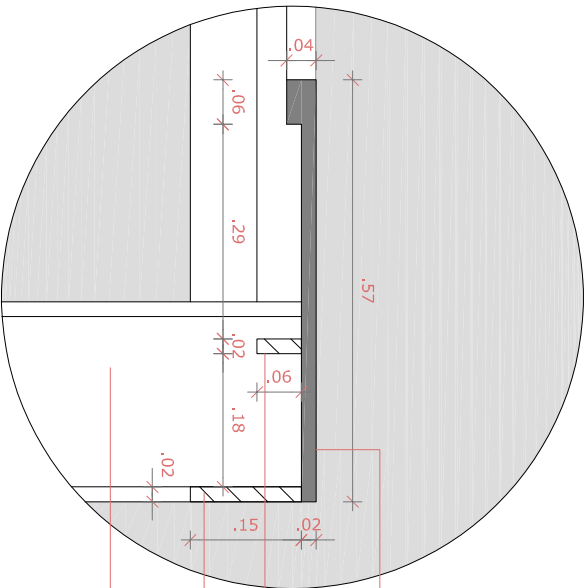

DET. MÓVEL COPA - VISTA A

ESCALA 1/10

- TAMPO MDF C/ LAMINADO MELAMINICO DE ALTA PRESSÃO CINZA CLARO
- ESTRUTURA – SUSTENTAÇÃO DO TAMPO
- ESTRUTURA – FIXAÇÃO NA PAREDE
- PÉS – MDF C/ LAMINADO MELAMINICO DE ALTA PRESSÃO CINZA CLARO
- MDF 18mm

PROJETO BÁSICO PARA PADRONIZAÇÃO  
DO EDIFÍCIO ASSIS BRASIL  
DETALHE BALCÃO COPA

## ANEXO 4 - CROQUI BALCÃO GRANITO

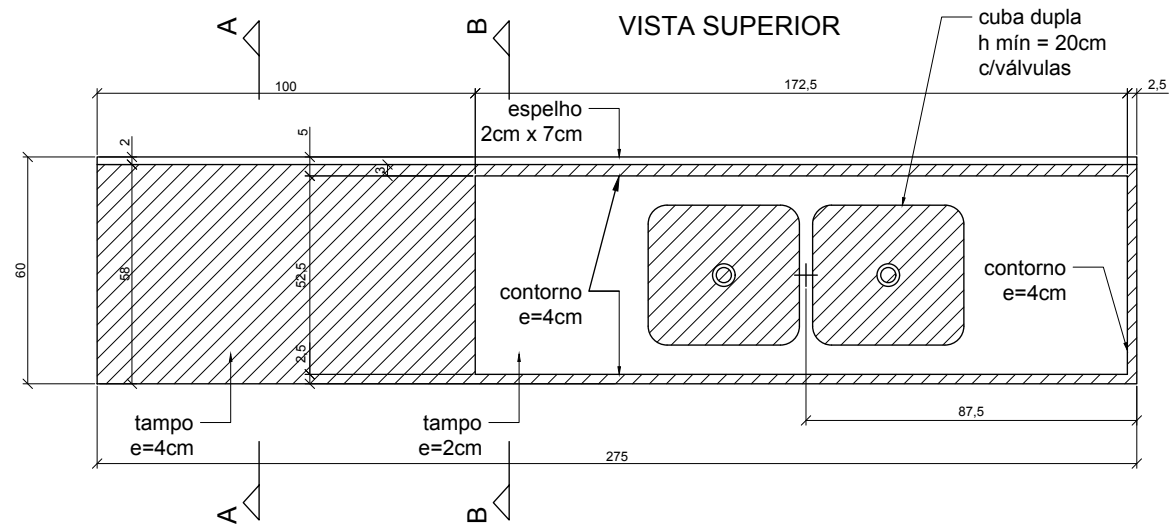

**CORTE A-A**

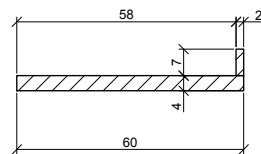

**CORTE B-B**

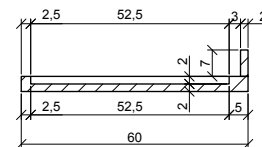

escala: 1/20